

- 1** Insert a coin and rotate counter clockwise.

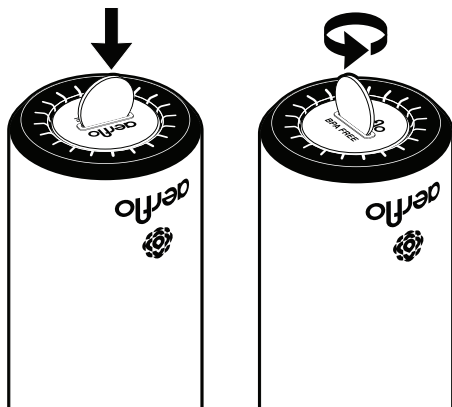

- 2** Separate each component and hand wash with warm, soapy water.

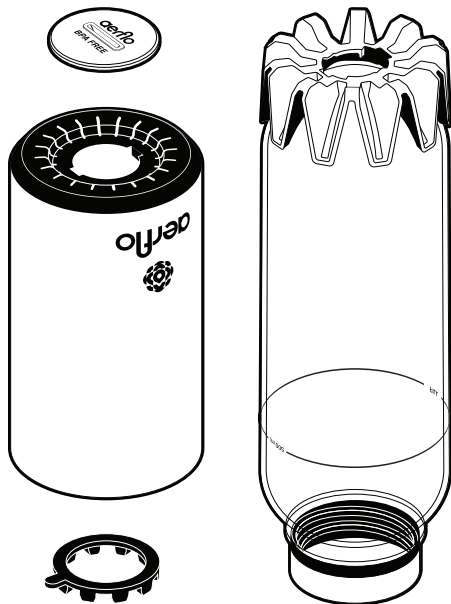

**aeriflo™**

How to clean  
your Aeriflo bottle

- 3** See reverse side for re-assembly instructions. →

- Allow bottle to dry before re-assembly
- Do not use water over 104°F/40°C
- Hand wash only, use mild soap

- 4** Hold bottle upside down.  
Insert Rubber spacer.

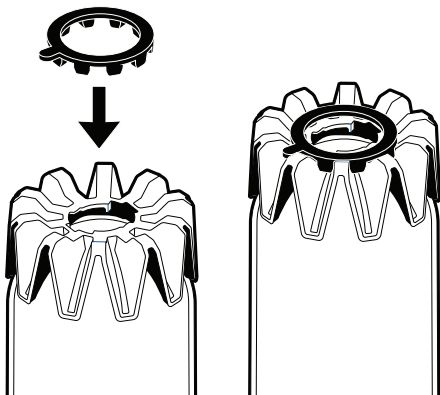

- 5** Slide on metal sleeve. Align each  
tab to its appropriate slot.

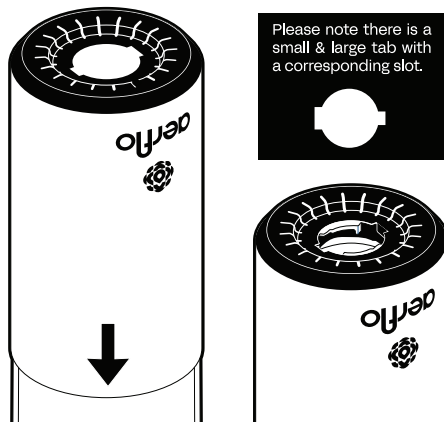

- 6** Insert locking cap and rotate  
clockwise using a coin.

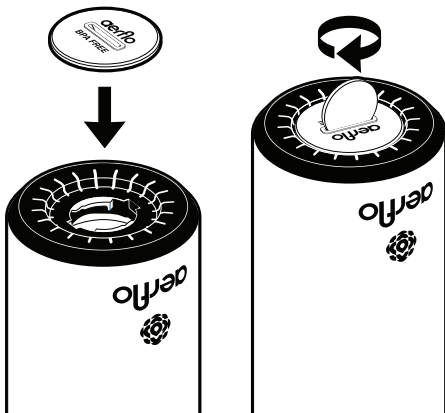

**Please discontinue use of the clear plastic vessel if it has experienced any of the following:**



Visible scuffs, nicks, cracks, or damage  
Exposure to temperatures 131°F/55°C+  
It has been in use for two years or more

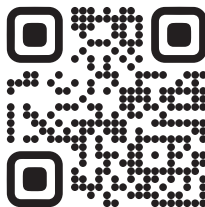

If any of the above issues have occurred, scan this QR code or visit [aerflo.co/btl](http://aerflo.co/btl) for information about exchanging your bottle.

